

MACHINED RING NEEDLE ROLLER BEARINGS

WITHOUT INNER RING

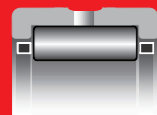

RNA49, RNA59, RNA69 (Fw ≤ 35), NK

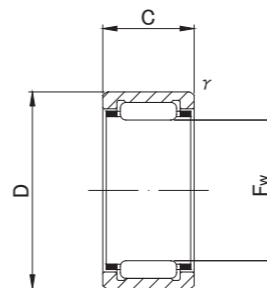

NK (Fw ≤ 10)

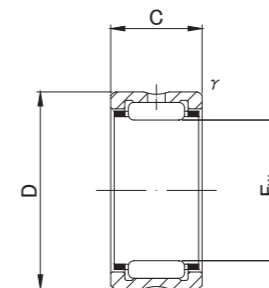

RNA49, RNA59, RNA69 (Fw ≤ 35), NK

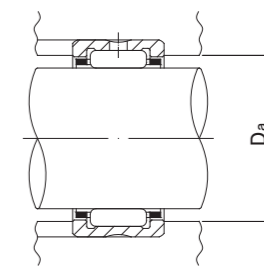

RNA49, RNA59, RNA69, RNA48, NK TYPE

Shaft Diameter (mm)	Designation					Dimensions (mm)				Standard mounting dimensions (mm)	Basic dynamic load rating	Basic static load rating	Limiting speed *	Mass	Usable bearing designation	
	RNA 49	RNA 59	RNA 69	RNA 48	NK	Fw	D	C	t/s min						Da MAX	Cr N
5	—	—	—	—	NK5/10	5 +0.018	10	10	0.15	6.5	2 420	1 950	40 000	3.4	—	—
	—	—	—	—	NK5/12	5 +0.010	10	12	0.15	6.5	3 080	2 660	40 000	4.2	—	—
6	—	—	—	—	NK6/10	6 +0.018	12	10	0.15	7.5	2 700	2 320	37 000	5.3	—	—
	—	—	—	—	NK6/12	6 +0.010	12	12	0.15	7.5	3 440	3 170	37 000	6.4	—	—
7	RNA 495	—	—	—	—	7 +0.022	13	10	0.15	8.5	2 960	2 690	34 000	5.9	IR5710	NA495
	—	—	—	—	NK7/10	7 +0.013	14	10	0.3	8.5	3 600	2 960	34 000	6.9	—	—
	—	—	—	—	NK7/12	7	14	12	0.3	8.5	4 610	4 050	34 000	8.3	—	—
8	RNA 496	—	—	—	—	8 +0.022	15	10	0.15	13.8	3 900	3 400	32 000	7.3	IR6810	NA496
	—	—	—	—	NK8/12	8 +0.013	15	12	0.3	13	5 100	4 700	32 000	9	IR5812	NKI 5/12
	—	—	—	—	NK8/16	8	15	16	0.3	13	7 100	7 300	32 000	13	IR5816	NKI 5/16
9	—	—	—	—	NK9/12	9 +0.022	16	12	0.3	14	5 500	5 300	30 000	10	IR6912	NKI 6/12
	—	—	—	—	NK9/16	9 +0.013	16	16	0.3	14	7 600	8 200	30 000	13.2	IR6916	NKI 6/16
	RNA 497	—	—	—	—	9	17	10	0.15	15.8	4 500	3 600	30 000	9.3	IR7910	NA497
10	—	—	—	—	NK10/12	10 +0.022	17	12	0.3	15	5 900	6 000	28 000	10.7	IR71012	NKI 7/12
	—	—	—	—	NK10/16	10 +0.013	17	16	0.3	15	8 200	9 200	28 000	14.3	IR71016	NKI 7/16
	RNA 498	—	—	—	—	10	19	11	0.2	17.4	6 200	5 000	28 000	12.6	IR81011	NA498
12	—	—	—	—	NK12/12	12 +0.027	19	12	0.3	17	6 600	7 300	26 000	12.2	IR91212	NKI 9/12
	—	—	—	—	NK12/16	12 +0.016	19	16	0.3	17	9 200	11 200	26 000	16.3	IR91216	NKI 9/16
	RNA 499	—	—	—	—	12	20	11	0.3	18	6 600	6 300	26 000	13.6	IR91211	NA499

* Suitable for oil lubrication. In case of grease lubrication, down to 60% of this value.

MACHINED RING NEEDLE ROLLER BEARINGS

WITHOUT INNER RING

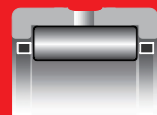

RNA49, RNA59, RNA69 (F_w ≤ 35), NK

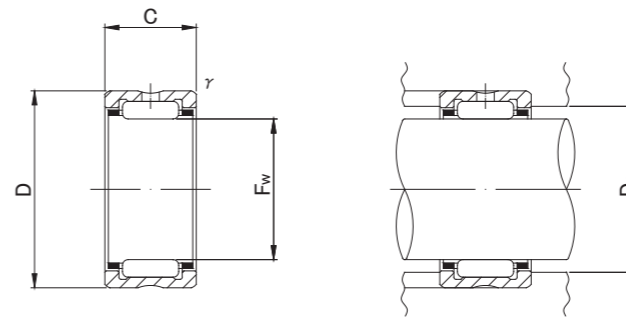

RNA49, RNA59, RNA69 (F_w ≤ 35), NK

RNA49, RNA59, RNA69, RNA48, NK TYPE

Shaft Diameter (mm)	Designation					Dimensions (mm)				Standard mounting dimensions (mm)	Basic dynamic load rating	Basic static load rating	Limiting speed *	Mass	Usable bearing designation								
	RNA 49	RNA 59	RNA 69	RNA 48	NK	F _w	D	C	r/s min						Da MAX	Cr N	Cor N	rpm	g (approx)	INNER RING	WITH INNER RING		
14	RNA 4900	—	—	—	—	14	+0.027 +0.016	22	13	0.3	20	9 200	10 100	24 000	16.5	IR101413	NA4900						
	—	—	—	—	NK14/16	22		16	0.3	20							11 800	13 700	24 000	21	IR101416	NKI 10/16	
	—	—	—	—	NK14/20	22		20	0.3	20							14 800	18 500	24 000	26.5	IR101420	NKI 10/20	
15	—	—	—	—	NK15/16	15	+0.027	23	16	0.3	21	12 400	14 900	23 000	22.5	—	—						
	—	—	—	—	NK15/20	15	+0.016	23	20	0.3								21	15 600	20 200	23 000	28	—
16	RNA 4901	—	—	—	—	16	+0.027 +0.016	24	13	0.3	22	9 700	11 100	23 000	18.1	IR121613	NA4901						
	—	—	—	—	NK16/16	16		24	16	0.3							22	12 300	15 100	23 000	23	IR121616	NKI 12/16
	—	—	—	—	NK16/20	16		24	20	0.3							22	15 600	20 400	23 000	29	IR121620	NKI 12/20
	—	—	RNA 6901	—	—	16		24	22	0.3							22	17 100	23 000	23 000	30	IR121622	NA6901
17	—	—	—	—	NK17/16	17	+0.027	25	16	0.3	23	12 800	16 300	22 000	24.5	—	—						
	—	—	—	—	NK17/20	17	+0.016	25	20	0.3								23	16 300	22 100	22 000	30.5	—
18	—	—	—	—	NK18/16	18	+0.027	26	16	0.3	24	13 400	17 500	21 000	25.5	—	—						
	—	—	—	—	NK18/20	18	+0.016	26	20	0.3								24	17 000	23 600	21 000	32	—
19	—	—	—	—	NK19/16	19	+0.033	27	16	0.3	25	14 000	18 700	21 000	27	IR151916	NKI 15/16						
	—	—	—	—	NK19/20	19	+0.020	27	20	0.3							25	17 700	25 300	21 000	34	IR151920	NKI 15/20
20	RNA 4902	—	—	—	—	20	+0.033 +0.020	28	13	0.3	26	10 900	13 800	20 000	21.5	IR152013	NA4902						
	—	—	—	—	NK20/16	20		28	16	0.3							26	13 900	18 700	20 000	27.5	—	—
	—	RNA 5902	—	—	—	20		28	18	0.3							26	15 700	22 100	20 000	33	IR152018	NA5902
	—	—	—	—	NK20/20	20		28	20	0.3							26	17 600	25 400	20 000	35.5	—	—
	—	—	RNA 6902	—	—	20		28	23	0.3							26	19 300	28 700	20 000	37	IR152023	NA6902

* Suitable for oil lubrication. In case of grease lubrication, down to 60% of this value.

MACHINED RING NEEDLE ROLLER BEARINGS

WITHOUT INNER RING

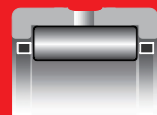

RNA49, RNA59, RNA69 (F_w ≤ 35), NK

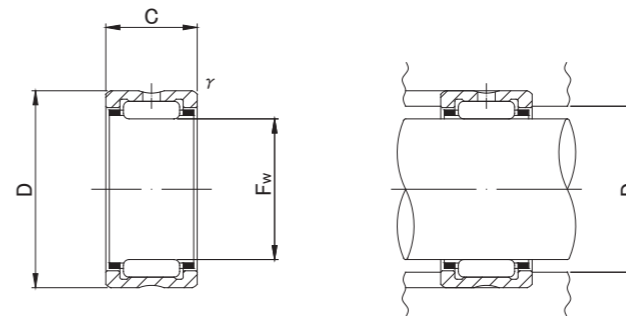

RNA49, RNA59, RNA69 (F_w ≤ 35), NK

RNA49, RNA59, RNA69, RNA48, NK TYPE

Shaft Diameter (mm)	Designation					Dimensions (mm)				Standard mounting dimensions (mm)	Basic dynamic load rating	Basic static load rating	Limiting speed *	Mass	Usable bearing designation								
	RNA 49	RNA 59	RNA 69	RNA 48	NK	F _w	D	C	r/s min						Da MAX	Cr N	Cor N	rpm	g (approx)	INNER RING	WITH INNER RING		
21	—	—	—	—	NK21/16 NK21/20	21 +0.033	29	16	0.3	27	14 400	20 000	19 000	29	IR172116	NKI 17/16							
	—	—	—	—		21 +0.020	29	20	0.3								27	18 200	27 100	19 000	36	IR172120	NKI 17/20
22	RNA 4903	—	—	—	— NK22/16 — NK22/20 —	22	30	13	0.3	28	11 800	15 600	18 000	23.5	IR172213	NA4903							
	—	—	—	—		22	30	16	0.3								28	14 900	21 200	18 000	30	—	—
	—	RNA 5903	—	—		22 +0.033	30	18	0.3								28	16 900	24 900	18 000	35	IR172218	NA5903
	—	—	—	—		22 +0.020	30	20	0.3								28	18 900	28 700	18 000	37.5	—	—
	—	—	RNA 6903	—		22	30	23	0.3								28	20 800	32 500	18 000	40.5	IR172223	NA6903
24	—	—	—	—	NK24/16 NK24/20	24 +0.033	32	16	0.3	30	15 300	22 600	17 000	32	IR202416	NKI 20/16							
	—	—	—	—		24 +0.020	32	20	0.3								30	19 400	30 500	17 000	40.5	IR202420	NKI 20/20
25	—	—	—	—	NK25/16 NK25/20 — — —	25	33	16	0.3	31	15 800	23 700	16 000	33.5	—	—							
	—	—	—	—		25	33	20	0.3								31	20 000	32 200	16 000	42	—	—
	RNA 4904	—	—	—		25 +0.033	37	17	0.3								35	21 000	25 000	16 000	55.5	IR202517	NA4904
	—	RNA 5904	—	—		25 +0.020	37	23	0.3								35	29 400	38 600	16 000	84	IR202523	NA5904
	—	—	RNA 6904	—		25	37	30	0.3								35	35 400	48 800	16 000	95.5	IR202530	NA6904
26	—	—	—	—	NK26/16 NK26/20	26 +0.033	34	16	0.3	32	16 300	24 900	15 000	34.5	IR222616	NKI 22/16							
	—	—	—	—		26 +0.020	34	20	0.3								32	20 600	33 700	15 000	43.5	IR222620	NKI 22/20
28	—	—	—	—	NK28/20 NK28/30 — — —	28	37	20	0.3	35	21 700	37 100	14 000	51.5	—	—							
	—	—	—	—		28	37	30	0.3								35	31 100	58 900	14 000	83.5	—	—
	RNA 49/22	—	—	—		28 +0.033	39	17	0.3								37	21 400	28 800	14 000	56.5	IR222817	NA49/22
	—	RNA 59/22	—	—		28 +0.020	39	23	0.3								37	29 800	44 400	14 000	92	IR222823	NA59/22
	—	—	RNA 69/22	—		28	39	30	0.3								37	36 300	56 900	14 000	97.5	IR222830	NA69/22
29	—	—	—	—	NK29/20 NK29/30	29 +0.033	38	20	0.3	36	21 600	37 200	14 000	57	IR252920	NKI 25/20							
	—	—	—	—		29 +0.020	38	30	0.3								36	30 900	59 000	14 000	85	IR252930	NKI 25/30

* Suitable for oil lubrication. In case of grease lubrication, down to 60% of this value.

MACHINED RING NEEDLE ROLLER BEARINGS

WITHOUT INNER RING

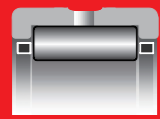

RNA49, RNA59, RNA69 ($F_w \leq 35$), NK RNA69

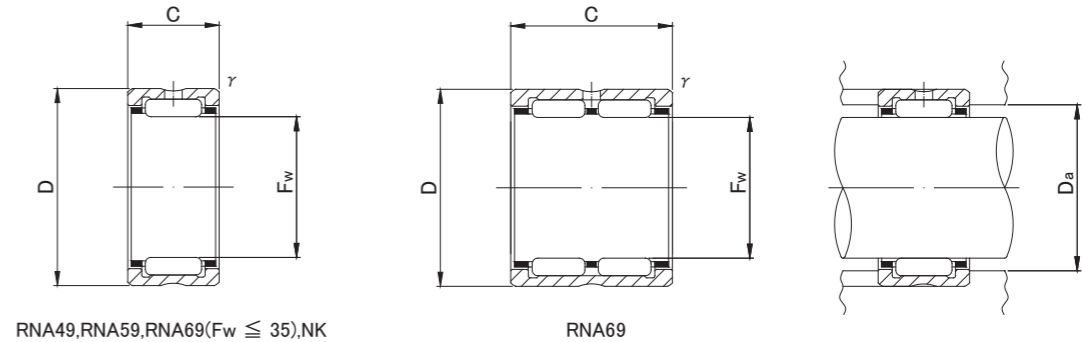

RNA49, RNA59, RNA69 ($F_w \leq 35$), NK

RNA69

RNA49, RNA59, RNA69, RNA48, NK TYPE

Shaft Diameter (mm)	Designation					Dimensions (mm)				Standard mounting dimensions (mm)	Basic dynamic load rating	Basic static load rating	Limiting speed *	Mass	Usable bearing designation	
	RNA 49	RNA 59	RNA 69	RNA 48	NK	F_w	D	C	t/s min						D_a MAX	Cr N
30	—	—	—	—	NK30/20	30	40	20	0.3	38	25 100	40 100	13 000	64.5	—	—
	—	—	—	—	NK30/30	30	40	30	0.3	38	36 000	63 800	13 000	97.5	—	—
	RNA 4905	—	—	—	—	30	42	17	0.3	40	23 700	30 700	13 000	64	IR253017	NA4905
	—	RNA 5905	—	—	—	30	42	23	0.3	40	33 200	47 500	13 000	101	IR253023	NA5905
	—	—	RNA 6905	—	—	30	42	30	0.3	40	42 100	64 200	13 000	111	IR253030	NA6905
32	—	—	—	—	NK32/20	32	42	20	0.3	40	25 700	42 200	13 000	68	IR283220	NKI 28/20
	—	—	—	—	NK32/30	32	42	30	0.3	40	36 900	67 100	13 000	102	IR283230	NKI 28/30
	RNA 49/28	—	—	—	—	32	45	17	0.3	43	24 500	32 700	13 000	76.5	IR283217	NA49/28
	—	RNA 59/28	—	—	—	32	45	23	0.3	43	34 300	50 500	13 000	108	IR283223	NA59/28
	—	—	RNA 69/28	—	—	32	45	30	0.3	43	41 800	64 700	13 000	133	IR283230	NA69/28
35	—	—	—	—	NK35/20	35	45	20	0.3	43	27 000	46 200	11 000	73.5	IR303520	NKI 30/20
	—	—	—	—	NK35/30	35	45	30	0.3	43	38 600	73 500	11 000	112	IR303530	NKI 30/30
	RNA 4906	—	—	—	—	35	47	17	0.3	45	25 200	34 700	11 000	72.5	IR303517	NA4906
	—	RNA 5906	—	—	—	35	47	23	0.3	45	35 200	53 700	11 000	108	IR303523	NA5906
	—	—	RNA 6906	—	—	35	47	30	0.3	45	43 100	69 000	11 000	125	IR303530	NA6906
37	—	—	—	—	NK37/20	37	47	20	0.3	45	28 200	50 100	11 000	77.5	IR323720	NKI 32/20
	—	—	—	—	NK37/30	37	47	30	0.3	45	40 500	79 800	11 000	117	IR323730	NKI 32/30
38	—	—	—	—	NK38/20	38	48	20	0.3	46	28 100	50 200	11 000	79	—	—
	—	—	—	—	NK38/30	38	48	30	0.3	46	40 300	80 000	11 000	119	—	—
40	—	—	—	—	NK40/20	40	50	20	0.3	48	29 400	54 100	10 000	83	IR354020	NKI 35/20
	—	—	—	—	NK40/30	40	50	30	0.3	48	42 300	86 100	10 000	125	IR354030	NKI 35/30
	RNA 49/32	—	—	—	—	40	52	20	0.6	48	31 300	47 900	10 000	96	IR324020	NA49/32
	—	RNA 59/32	—	—	—	40	52	27	0.6	48	41 900	69 900	10 000	149	IR324027	NA59/32
	—	—	RNA 69/32	—	—	40	52	36	0.6	48	53 500	95 700	10 000	172	IR324036	NA69/32
42	—	—	—	—	NK42/20	42	52	20	0.3	50	29 900	56 200	9 500	86.5	—	—
	—	—	—	—	NK42/30	42	52	30	0.3	50	43 000	89 500	9 500	130	—	—
	RNA 4907	—	—	—	—	42	55	20	0.6	51	32 000	50 200	9 500	113	IR354220	NA4907
	—	RNA 5907	—	—	—	42	55	27	0.6	51	42 900	73 200	9 500	176	IR354227	NA5907
	—	—	RNA 6907	—	—	42	55	36	0.6	51	54 800	100 000	9 500	200	IR354236	NA6907

* Suitable for oil lubrication. In case of grease lubrication, down to 60% of this value.

MACHINED RING NEEDLE ROLLER BEARINGS

WITHOUT INNER RING

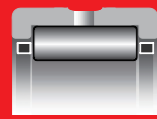

RNA49, RNA59, RNA48, NK



RNA69

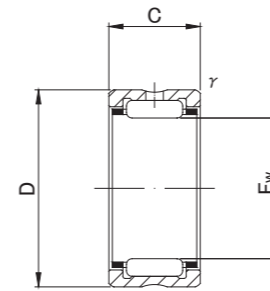

RNA49, RNA59, RNA48, NK

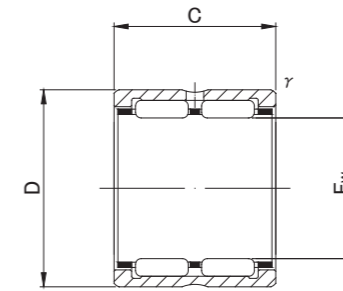

RNA69

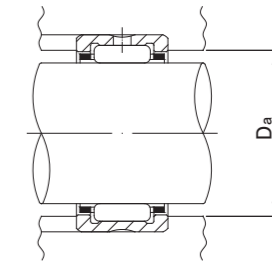

RNA49, RNA59, RNA69, RNA48, NK TYPE

Shaft Diameter (mm)	Designation					Dimensions (mm)				Standard mounting dimensions (mm)	Basic dynamic load rating	Basic static load rating	Limiting speed *	Mass	Usable bearing designation		
	RNA 49	RNA 59	RNA 69	RNA 48	NK	Fw	D	C	t/s min						Da MAX	Cr N	Cor N
43	—	—	—	—	NK43/20 NK43/30	43 +0.041	53	20	0.3	51	30 500 43 700	58 100 92 500	9 500 9 500	88.5 133	IR384320 IR384330	NKI 38/20 NKI 38/30	
	—	—	—	—		43 +0.025	53	30	0.3								51
45	—	—	—	—	NK45/20 NK45/30	45 +0.041	55	20	0.3	53	31 100 44 500	60 100 95 700	9 000 9 000	92 138	IR404520 IR404530	NKI 40/20 NKI 40/30	
	—	—	—	—		45 +0.025	55	30	0.3								53
47	—	—	—	—	NK47/20 NK47/30	47 +0.041	57	20	0.3	55	31 500 45 200	62 300 99 000	8 500 8 500	95 144	IR424720 IR424730	NKI 42/20 NKI 42/30	
	—	—	—	—		47 +0.025	57	30	0.3								55
48	RNA 4908	—	—	—	—	48 +0.041	62	22	0.6	58	41 600 58 000 71 300	67 400 103 000 134 400	8 500 8 500 8 500	152 225 275	IR404822 IR404830 IR404840	NA4908 NA5908 NA6908	
	—	RNA 5908	—	—		48 +0.025	62	30	0.6								58
	—	—	RNA 6908	—		48	62	40	0.6								58
50	—	—	—	—	NK50/25 NK50/35	50 +0.041	62	25	0.6	58	43 000 58 100	85 200 125 500	8 000 8 000	159 225	IR455025 IR455035	NKI 45/25 NKI 45/35	
	—	—	—	—		50 +0.025	62	35	0.6								58
52	RNA 4909	—	—	—	—	52 +0.049	68	22	0.6	64	43 500 60 700 74 600	73 400 112 000 147 100	7 500 7 500 7 500	197 232 355	IR455222 IR455230 IR455240	NA4909 NA5909 NA6909	
	—	RNA 5909	—	—		52 +0.030	68	30	0.6								64
	—	—	RNA 6909	—		52	68	40	0.6								64
55	—	—	—	—	NK55/25 NK55/35	55 +0.049	68	25	0.6	64	45 400 61 300	94 100 138 300	7 500 7 500	193 255	IR505525 IR505535	NKI 50/25 NKI 50/35	
	—	—	—	—		55 +0.030	68	35	0.6								64

* Suitable for oil lubrication. In case of grease lubrication, down to 60% of this value.

MACHINED RING NEEDLE ROLLER BEARINGS

WITHOUT INNER RING

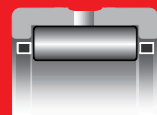

RNA49, RNA59, RNA48, NK



RNA69

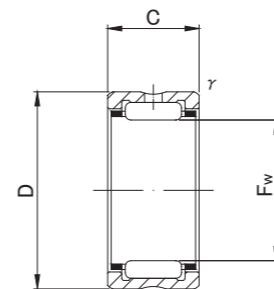

RNA49, RNA59, RNA48, NK

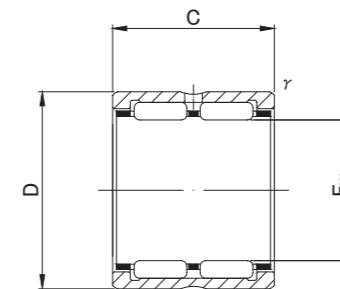

RNA69

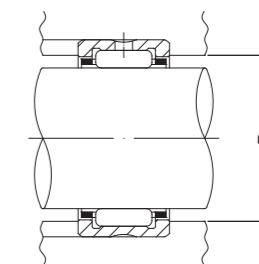

RNA49, RNA59, RNA69, RNA48, NK TYPE

Shaft Diameter (mm)	Designation					Dimensions (mm)				Standard mounting dimensions (mm)	Basic dynamic load rating	Basic static load rating	Limiting speed *	Mass	Usable bearing designation										
	RNA 49	RNA 59	RNA 69	RNA 48	NK	Fw	D	C	t's min						Da MAX	Cr N	Cor N	rpm	g (approx)	INNER RING	WITH INNER RING				
58	RNA 4910	—	—	—	—	58	+0.049 +0.030	72	22	0.6	68	46 200 64 400 79 100	82 100 126 000 163 800	7 000 7 000 7 000	179 289 320	IR505822 IR505830 IR505840	NA4910 NA5910 NA6910								
	—	RNA 5910	—	—	—	58		72	30	0.6								68	64 400	126 000	7 000	289	IR505830	NA5910	
	—	—	RNA 6910	—	—	58		72	40	0.6								68	79 100	163 800	7 000	320	IR505840	NA6910	
60	—	—	—	—	NK60/25	60	+0.049 +0.030	72	25	0.6	68	47 500 64 100	103 000 151 000	6 500 6 500	187 260	IR556025 IR556035	NKI 55/25 NKI 55/35								
	—	—	—	—	NK60/35			72	35	0.6								68	64 100	151 000	6 500	260	IR556035	NKI 55/35	
63	RNA 4911	—	—	—	—	63	+0.049 +0.030	80	25	1	75	57 600 82 600 99 000	97 300 154 000 194 200	6 500 6 500 6 500	265 367 475	IR556325 IR556334 IR556345	NA4911 NA5911 NA6911								
	—	RNA 5911	—	—	—			63	80	34								1	75	82 600	154 000	6 500	367	IR556334	NA5911
	—	—	RNA 6911	—	—			63	80	45								1	75	99 000	194 200	6 500	475	IR556345	NA6911
65	—	—	—	—	NK65/25	65	+0.049 +0.030	78	25	0.6	74	49 600 67 000	111 800 164 800	6 000 6 000	225 315	— —	— —								
	—	—	—	—	NK65/35			78	35	0.6								74	67 000	164 800	6 000	315	—	—	
68	—	—	—	—	NK68/25	68	+0.049 +0.030	82	25	0.6	78	54 800 72 100 60 100 86 100 103 000	116 700 165 700 104 900 167 000 210 800	6 000 6 000 6 000 6 000 6 000	250 350 285 408 510	IR606825 IR606835 IR606825 IR606834 IR606845	NKI 60/25 NKI 60/35 NA4912 NA5912 NA6912								
	—	—	—	—	NK68/35			82	35	0.6								78	72 100	165 700	6 000	350	IR606835	NKI 60/35	
	RNA 4912	—	—	—	—			68	85	25								1	80	60 100	104 900	6 000	285	IR606825	NA4912
	—	RNA 5912	—	—	—			68	85	34								1	80	86 100	167 000	6 000	408	IR606834	NA5912
	—	—	RNA 6912	—	—			68	85	45								1	80	103 000	210 800	6 000	510	IR606845	NA6912
70	—	—	—	—	NK70/25	70	+0.049 +0.030	85	25	0.6	81	55 500 73 000	120 600 170 600	5 500 5 500	280 395	— —	— —								
	—	—	—	—	NK70/35			85	35	0.6								81	73 000	170 600	5 500	395	—	—	
72	RNA 4913	—	—	—	—	72	+0.049 +0.030	90	25	1	85	62 800 89 900 107 900	113 800 180 000 226 500	5 500 5 500 5 500	325 462 585	IR657225 IR657234 IR657245	NA4913 NA5913 NA6913								
	—	RNA 5913	—	—	—			72	90	34								1	85	89 900	180 000	5 500	462	IR657234	NA5913
	—	—	RNA 6913	—	—			72	90	45								1	85	107 900	226 500	5 500	585	IR657245	NA6913

* Suitable for oil lubrication. In case of grease lubrication, down to 60% of this value.

MACHINED RING NEEDLE ROLLER BEARINGS

WITHOUT INNER RING

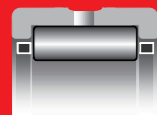

RNA49, RNA59, RNA48, NK



RNA69

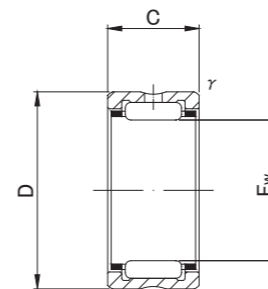

RNA49, RNA59, RNA48, NK

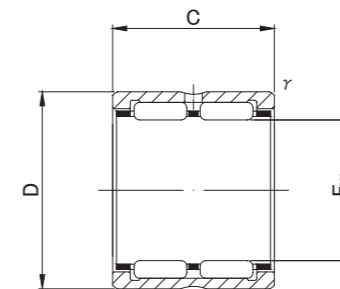

RNA69

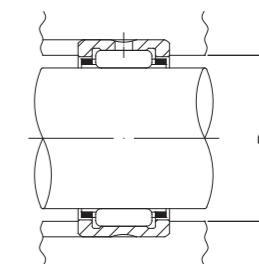

RNA49, RNA59, RNA69, RNA48, NK TYPE

Shaft Diameter (mm)	Designation					Dimensions (mm)				Standard mounting dimensions (mm)	Basic dynamic load rating	Basic static load rating	Limiting speed *	Mass	Usable bearing designation								
	RNA 49	RNA 59	RNA 69	RNA 48	NK	Fw	D	C	t/s min						Da MAX	Cr N	Cor N	rpm	g (approx)	INNER RING	WITH INNER RING		
73	—	—	—	—	NK73/25 NK73/35	73 +0.049	90	25	0.6	86	61 100	126 500	5 500	335	—	—							
	—	—	—	—		73 +0.030	90	35	0.6								86	80 400	180 400	5 500	475	IR657335	NKI 65/35
75	—	—	—	—	NK75/25 NK75/35	75 +0.049	92	25	0.6	88	62 200	130 400	5 500	345	—	—							
	—	—	—	—		75 +0.030	92	35	0.6								88	82 700	186 300	5 500	485	—	—
80	—	—	—	—	NK80/25 NK80/35	80	95	25	1	90	59 400	137 300	5 000	315	IR708025	NKI 70/25							
	—	—	—	—		80	95	35	1								90	78 100	194 200	5 000	445	IR708035	NKI 70/35
	RNA 4914	—	—	—		80 +0.049	100	30	1								95	83 200	157 900	5 000	495	IR708030	NA4914
	—	RNA 5914	—	—		80 +0.030	100	40	1								95	112 000	232 000	5 000	706	IR708040	NA5914
	—	—	RNA 6914	—		80	100	54	1								95	133 400	310 900	5 000	910	IR708054	NA6914
85	—	—	—	—	NK85/25 NK85/35	85	105	25	1	100	76 400	145 100	4 500	435	IR758525	NKI 75/25							
	RNA 4915	—	—	—		85	105	30	1								100	86 200	169 700	4 500	525	IR758530	NA4915
	—	—	—	—		85 +0.058	105	35	1								100	102 000	209 900	4 500	610	IR758535	NKI 75/35
	—	RNA 5915	—	—		85 +0.036	105	40	1								100	116 000	249 000	4 500	745	IR758540	NA5915
	—	—	RNA 6915	—		85	105	54	1								100	138 300	330 500	4 500	960	IR758554	NA6915
90	—	—	—	—	NK90/25 NK90/35	90	110	25	1	105	77 400	150 000	4 500	456	IR809025	NKI 80/25							
	RNA 4916	—	—	—		90	110	30	1								105	87 400	174 600	4 500	550	IR809030	NA4916
	—	—	—	—		90 +0.058	110	35	1								105	103 000	216 700	4 500	640	IR809035	NKI 80/35
	—	RNA 5916	—	—		90 +0.036	110	40	1								105	117 000	257 000	4 500	787	IR809040	NA5916
	—	—	RNA 6916	—		90	110	54	1								105	143 200	350 100	4 500	1 010	IR809054	NA6916
95	—	—	—	—	NK95/26 NK95/36	95 +0.058	115	26	1	110	79 700	158 900	4 200	495	IR859526	NKI 85/26							
	—	—	—	—		95 +0.036	115	36	1								110	106 900	230 500	4 200	690	IR859536	NKI 85/36
100	—	—	—	—	NK100/26 NK100/36	100	120	26	1	115	82 500	168 700	4 000	525	IR9010026	NKI 90/26							
	RNA 4917	—	—	—		100	120	35	1.1								113.5	109 800	244 200	4 000	705	IR8510035	NA4917
	—	—	—	—		100 +0.058	120	36	1								115	109 800	244 200	4 000	725	IR9010036	NKI 90/36
	—	RNA 5917	—	—		100 +0.036	120	46	1.1								113.5	144 000	346 000	4 000	1 000	IR8510046	NA5917
	—	—	RNA 6917	—		100	120	63	1.1								113.5	172 600	466 800	4 000	1 300	IR8510063	NA6917

* Suitable for oil lubrication. In case of grease lubrication, down to 60% of this value.

MACHINED RING NEEDLE ROLLER BEARINGS

WITHOUT INNER RING

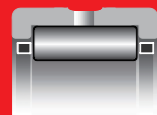

RNA49, RNA59, RNA48, NK



RNA69

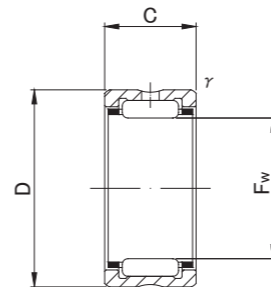

RNA49, RNA59, RNA48, NK

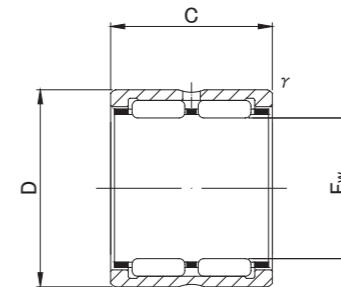

RNA69

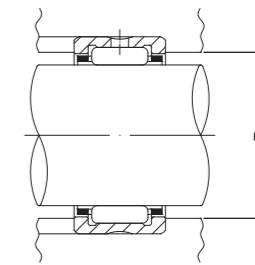

RNA49, RNA59, RNA69, RNA48, NK TYPE

Shaft Diameter (mm)	Designation					Dimensions (mm)				Standard mounting dimensions (mm)	Basic dynamic load rating	Basic static load rating	Limiting speed *	Mass	Usable bearing designation	
	RNA 49	RNA 59	RNA 69	RNA 48	NK	Fw	D	C	t/s min						Da MAX	Cr N
105	—	—	—	—	NK105/26	105	125	26	1	120	84 700	177 500	3 800	545	IR9510526	NKI 95/26
	RNA 4918	—	—	—	—	105	125	35	1.1	118.5	112 800	257 900	3 800	740	IR9010535	NA4918
	—	—	—	—	NK105/36	105 ^{+0.058}	125	36	1	120	112 800	257 900	3 800	760	IR9510536	NKI 95/36
	—	RNA 5918	—	—	—	105 ^{+0.036}	125	46	1.1	118.5	148 000	365 000	3 800	1 040	IR9010546	NA5918
	—	—	RNA 6918	—	—	105	125	63	1.1	118.5	177 500	490 300	3 800	1 360	IR9010563	NA6918
110	—	—	—	—	NK110/30	110	130	30	1.1	123.5	105 900	239 300	3 600	660	IR10011030	NKI 100/30
	RNA 4919	—	—	—	—	110	130	35	1.1	123.5	116 700	270 700	3 600	770	IR9511035	NA4919
	—	—	—	—	NK110/40	110 ^{+0.058}	130	40	1.1	123.5	133 400	323 600	3 600	880	IR10011040	NKI 100/40
	—	RNA 5919	—	—	—	110 ^{+0.036}	130	46	1.1	123.5	152 000	384 000	3 600	1 130	IR9511046	NA5919
	—	—	RNA 6919	—	—	110	130	63	1.1	123.5	182 400	514 800	3 600	1 420	IR9511063	NA6919
115	RNA 4920	—	—	—	—	115 ^{+0.058}	140	40	1.1	133.5	145 000	329 000	3 500	1 190	IR10011540	NA4920
120	—	—	—	RNA 4822	—	120 ^{+0.058}	140	30	1	135	93 000	239 000	3 500	790	IR11012030	NA4822
125	RNA 4922	—	—	—	—	125 ^{+0.068}	150	40	1.1	143.5	152 000	357 000	3 000	1 280	IR11012540	NA4922
130	—	—	—	RNA 4824	—	130 ^{+0.068}	150	30	1	145	97 000	259 000	3 000	850	IR12013030	NA4824
135	RNA 4924	—	—	—	—	135 ^{+0.068}	165	45	1.1	158.5	187 000	435 000	3 000	1 930	IR12013545	NA4924

* Suitable for oil lubrication. In case of grease lubrication, down to 60% of this value.

MACHINED RING NEEDLE ROLLER BEARINGS

WITHOUT INNER RING

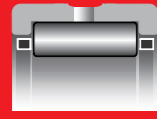

RNA49, RNA59, RNA48, NK



RNA69

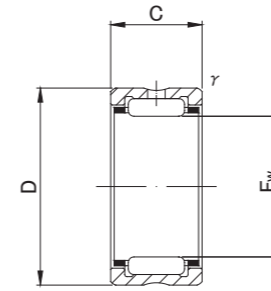

RNA49, RNA59, RNA48, NK

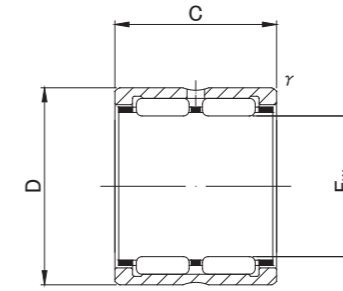

RNA69

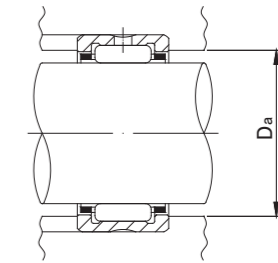

RNA49, RNA59, RNA69, RNA48, NK TYPE

Shaft Diameter (mm)	Designation					Dimensions (mm)				Standard mounting dimensions (mm)	Basic dynamic load rating	Basic static load rating	Limiting speed *	Mass	Usable bearing designation	
	RNA 49	RNA 59	RNA 69	RNA 48	NK	Fw	D	C	t/s min						Da MAX	Cr N
145	—	—	—	RNA 4826	—	145 ^{+0.068} / _{+0.043}	165	35	1.1	158.5	117 000	340 000	3 000	1 100	IR13014535	NA4826
150	RNA 4926	—	—	—	—	150 ^{+0.068} / _{+0.043}	180	50	1.5	172	216 000	540 000	2 500	2 360	IR13015050	NA4926
155	—	—	—	RNA 4828	—	155 ^{+0.068} / _{+0.043}	175	35	1.1	168.5	121 000	363 000	2 500	1 170	IR14015535	NA4828
160	RNA 4928	—	—	—	—	160 ^{+0.068} / _{+0.043}	190	50	1.5	182	224 000	580 000	2 500	2 500	IR14016050	NA4928
165	—	—	—	RNA 4830	—	165 ^{+0.068} / _{+0.043}	190	40	1.1	183.5	168 000	446 000	2 500	1 750	IR15016540	NA4830
175	—	—	—	RNA 4832	—	175 ^{+0.068} / _{+0.043}	200	40	1.1	193.5	173 000	474 000	2 500	1 850	IR16017540	NA4832

* Suitable for oil lubrication. In case of grease lubrication, down to 60% of this value.

MACHINED RING NEEDLE ROLLER BEARINGS

WITH INNER RING

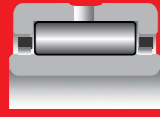

NA49,NA59,NA69(d≤30),NKI

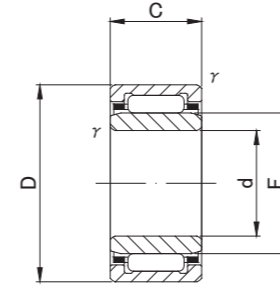

NKI(d ≤ 8)

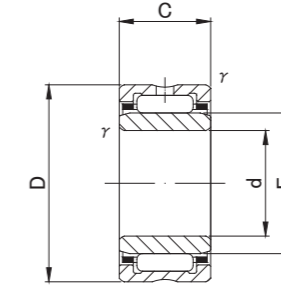

NA49,NA59,NA69(d ≤ 30),NKI

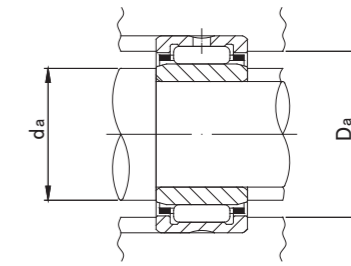

■ NA49,NA59,NA69,NA48,NKI TYPE

Shaft Diameter (mm)	Designation					Dimensions (mm)						Standard mounting dimensions (mm)		Basic dynamic load rating	Basic static load rating	Limiting speed*	Mass	Usable bearing designation	
	NA 49	NA 59	NA 69	NA48	NKI	d	D	C	r/s min	F	da		Da MAX	Cr N	Cor N	rpm	g (approx)	OUTER RING	INNER RING
											MIN	MAX							
5	NA495	—	—	—	—	5	13	10	0.15	7	6.2	6.7	11.8	2 960	2 690	34 000	7.3	RNA495	IR5710
	—	—	—	—	NKI 5/12	5 ⁰	15	12	0.3	8	7	7.7	13	5 100	4 700	32 000	11.9	NK8/12	IR5812
	—	—	—	—	NKI 5/16	5 ^{-0.008}	15	16	0.3	8	7	7.7	13	7 100	7 300	32 000	16.7	NK8/16	IR5816
6	NA 496	—	—	—	—	6	15	10	0.15	8	7.2	7.7	13.8	3 900	3 400	32 000	9.1	RNA496	IR6810
	—	—	—	—	NKI 6/12	6 ⁰	16	12	0.3	9	8	8.7	14	5 500	5 300	30 000	13	NK9/12	IR6912
	—	—	—	—	NKI 6/16	6 ^{-0.008}	16	16	0.3	9	8	8.7	14	7 600	8 200	30 000	17.5	NK9/16	IR6916
7	NA 497	—	—	—	—	7	17	10	0.15	9	8.2	8.7	15.8	4 500	3 600	30 000	11.2	RNA497	IR7910
	—	—	—	—	NKI 7/12	7 ⁰	17	12	0.3	10	9	9.7	15	5 900	6 000	28 000	14.3	NK10/12	IR71012
	—	—	—	—	NKI 7/16	7 ^{-0.008}	17	16	0.3	10	9	9.7	15	8 200	9 200	28 000	19.2	NK10/16	IR71016
8	NA 498	—	—	—	—	8	19	11	0.2	10	9.2	9.7	17.4	6 200	5 000	28 000	15	RNA498	IR81011
9	—	—	—	—	NKI 9/12	9	19	12	0.3	12	11	11.5	17	6 600	7 300	26 000	16.7	NK12/12	IR91212
	—	—	—	—	NKI 9/16	9 ⁰	19	16	0.3	12	11	11.5	17	9 200	11 200	26 000	22.5	NK12/16	IR91216
	NA 499	—	—	—	—	9 ^{-0.008}	20	11	0.3	12	11	11.5	18	6 600	6 300	26 000	16.7	RNA499	IR91211
10	NA 4900	—	—	—	—	10	22	13	0.3	14	12	13	20	9 200	10 100	24 000	24	RNA4900	IR101413
	—	—	—	—	NKI 10/16	10 ⁰	22	16	0.3	14	12	13	20	11 800	13 700	24 000	30	NK14/16	IR101416
	—	—	—	—	NKI 10/20	10 ^{-0.008}	22	20	0.3	14	12	13	20	14 800	18 500	24 000	38	NK14/20	IR101420
12	NA 4901	—	—	—	—	12	24	13	0.3	16	14	15	22	9 700	11 100	23 000	26.5	RNA4901	IR121613
	—	—	—	—	NKI 12/16	12 ⁰	24	16	0.3	16	14	15	22	12 300	15 100	23 000	33.5	NK16/16	IR121616
	—	—	—	—	NKI 12/20	12 ^{-0.008}	24	20	0.3	16	14	15	22	15 600	20 400	23 000	42.5	NK16/20	IR121620
	—	—	NA 6901	—	—	12	24	22	0.3	16	14	15	22	17 100	23 000	23 000	44.5	RNA6901	IR121622

* Suitable for oil lubrication. In case of grease lubrication, down to 60% of this value.

MACHINED RING NEEDLE ROLLER BEARINGS

WITH INNER RING

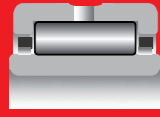

NA49,NA59,NA69(d≤30),NKI

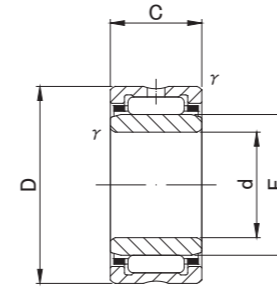

NA49,NA59,NA69(d ≤ 30),NKI

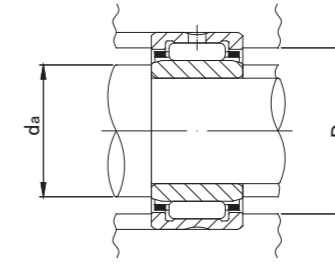

NA49,NA59,NA69,NA48,NKI TYPE

Shaft Diameter (mm)	Designation					Dimensions (mm)						Standard mounting dimensions (mm)		Basic dynamic load rating	Basic static load rating	Limiting speed*	Mass	Usable bearing designation	
	NA 49	NA 59	NA 69	NA48	NKI	d	D	C	r/s min	F	da		Da MAX	Cr N	Cor N	rpm	g (approx)	OUTER RING	INNER RING
											MIN	MAX							
15	—	—	—	—	NKI 15/16	15	27	16	0.3	19	17	18	25	14 000	18 700	21 000	39.5	NK19/16	IR151916
	—	—	—	—	NKI 15/20	15	27	20	0.3	19	17	18	25	17 700	25 300	21 000	50	NK19/20	IR151920
	NA 4902	—	—	—	—	15 ⁰ _{-0.008}	28	13	0.3	20	17	19	26	10 900	13 800	20 000	35	RNA4902	IR152013
	—	NA 5902	—	—	—	15	28	18	0.3	20	17	19	26	15 700	22 100	20 000	52	RNA5902	IR152018
	—	—	NA 6902	—	—	15	28	23	0.3	20	17	19	26	19 300	28 700	20 000	61	RNA6902	IR152023
17	—	—	—	—	NKI 17/16	17	29	16	0.3	21	19	20	27	14 400	20 000	19 000	43.5	NK21/16	IR172116
	—	—	—	—	NKI 17/20	17	29	20	0.3	21	19	20	27	18 200	27 100	19 000	54	NK21/20	IR172120
	NA 4903	—	—	—	—	17 ⁰ _{-0.008}	30	13	0.3	22	19	21	28	11 800	15 600	18 000	39	RNA4903	IR172213
	—	NA 5903	—	—	—	17	30	18	0.3	22	19	21	28	16 900	24 900	18 000	56	RNA5903	IR172218
	—	—	NA 6903	—	—	17	30	23	0.3	22	19	21	28	20 800	32 500	18 000	67	RNA6903	IR172223
20	—	—	—	—	NKI 20/16	20	32	16	0.3	24	22	23	30	15 300	22 600	17 000	48.5	NK24/16	IR202416
	—	—	—	—	NKI 20/20	20	32	20	0.3	24	22	23	30	19 400	30 500	17 000	61	NK24/20	IR202420
	NA 4904	—	—	—	—	20 ⁰ _{-0.010}	37	17	0.3	25	22	24	35	21 000	25 000	16 000	78.5	RNA4904	IR202517
	—	NA 5904	—	—	—	20	37	23	0.3	25	22	24	35	29 400	38 600	16 000	115	RNA5904	IR202523
	—	—	NA 6904	—	—	20	37	30	0.3	25	22	24	35	35 400	48 800	16 000	136	RNA6904	IR202530
22	—	—	—	—	NKI 22/16	22	34	16	0.3	26	24	25	32	16 300	24 900	15 000	52	NK26/16	IR222616
	—	—	—	—	NKI 22/20	22	34	20	0.3	26	24	25	32	20 600	33 700	15 000	67.5	NK26/20	IR222620
	NA 49/22	—	—	—	—	22 ⁰ _{-0.010}	39	17	0.3	28	24	27	37	21 400	28 800	14 000	87	RNA49/22	IR222817
	—	NA 59/22	—	—	—	22	39	23	0.3	28	24	27	37	29 800	44 400	14 000	134	RNA59/22	IR222823
	—	—	NA 69/22	—	—	22	39	30	0.3	28	24	27	37	36 300	56 900	14 000	152	RNA69/22	IR222830
25	—	—	—	—	NKI 25/20	25	38	20	0.3	29	27	28	36	21 600	37 200	14 000	82	NK29/20	IR252920
	—	—	—	—	NKI 25/30	25	38	30	0.3	29	27	28	36	30 900	59 000	14 000	123	NK29/30	IR252930
	NA 4905	—	—	—	—	25 ⁰ _{-0.010}	42	17	0.3	30	27	29	40	23 700	30 700	13 000	92.5	RNA4905	IR253017
	—	NA 5905	—	—	—	25	42	23	0.3	30	27	29	40	33 200	47 500	13 000	139	RNA5905	IR253023
	—	—	NA 6905	—	—	25	42	30	0.3	30	27	29	40	42 100	64 200	13 000	160	RNA6905	IR253030
28	—	—	—	—	NKI 28/20	28	42	20	0.3	32	30	31	40	25 700	42 200	13 000	96.5	NK32/20	IR283220
	—	—	—	—	NKI 28/30	28	42	30	0.3	32	30	31	40	36 900	67 100	13 000	145	NK32/30	IR283230
	NA 49/28	—	—	—	—	28 ⁰ _{-0.010}	45	17	0.3	32	30	31	43	24 500	32 700	13 000	101	RNA49/28	IR283217
	—	NA 59/28	—	—	—	28	45	23	0.3	32	30	31	43	34 300	50 500	13 000	142	RNA59/28	IR283223
	—	—	NA 69/28	—	—	28	45	30	0.3	32	30	31	43	41 800	64 700	13 000	176	RNA69/28	IR283230
30	—	—	—	—	NKI 30/20	30	45	20	0.3	35	32	34	43	27 000	46 200	11 000	112	NK35/20	IR303520
	—	—	—	—	NKI 30/30	30	45	30	0.3	35	32	34	43	38 600	73 500	11 000	171	NK35/30	IR303530
	NA 4906	—	—	—	—	30 ⁰ _{-0.010}	47	17	0.3	35	32	34	45	25 200	34 700	11 000	106	RNA4906	IR303517
	—	NA 5906	—	—	—	30	47	23	0.3	35	32	34	45	35 200	53 700	11 000	152	RNA5906	IR303523
	—	—	NA 6906	—	—	30	47	30	0.3	35	32	34	45	43 100	69 000	11 000	184	RNA6906	IR303530

* Suitable for oil lubrication. In case of grease lubrication, down to 60% of this value.

MACHINED RING NEEDLE ROLLER BEARINGS

WITH INNER RING

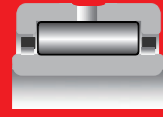

NA49,NA59,NA69(d ≤ 30),NKI



NA69

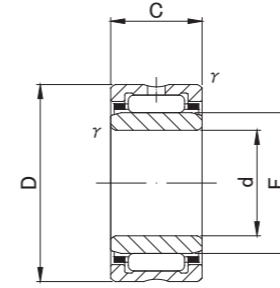

NA49,NA59,NA69(d ≤ 30),NKI

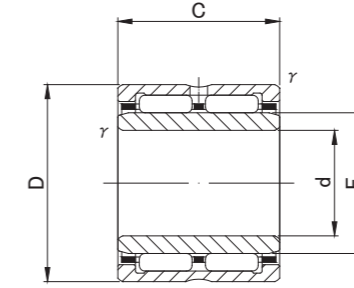

NA69

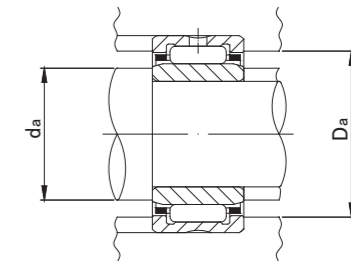

■ NA49,NA59,NA69,NA48,NKI TYPE

Shaft Diameter (mm)	Designation					Dimensions (mm)						Standard mounting dimensions (mm)		Basic dynamic load rating	Basic static load rating	Limiting speed*	Mass	Usable bearing designation	
	NA 49	NA 59	NA 69	NA48	NKI	d	D	C	r/s min	F	da		Da MAX	Cr N	Cor N	rpm	g (approx)	OUTER RING	INNER RING
											MIN	MAX							
32	—	—	—	—	NKI 32/20	32	47	20	0.3	37	34	36	45	28 200	50 100	11 000	121	NK37/20	IR323720
	—	—	—	—	NKI 32/30	32	47	30	0.3	37	34	36	45	40 500	79 800	11 000	180	NK37/30	IR323730
	NA 49/32	—	—	—	—	32 ⁰ _{-0.012}	52	20	0.6	40	36	39	48	31 300	47 900	10 000	165	RNA49/32	IR324020
	—	NA 59/32	—	—	—	32	52	27	0.6	40	36	39	48	41 900	69 900	10 000	241	RNA59/32	IR324027
	—	—	NA 69/32	—	—	32	52	36	0.6	40	36	39	48	53 500	95 700	10 000	295	RNA69/32	IR324036
35	—	—	—	—	NKI 35/20	35	50	20	0.3	40	37	39	48	29 400	54 100	10 000	129	NK40/20	IR354020
	—	—	—	—	NKI 35/30	35	50	30	0.3	40	37	39	48	42 300	86 100	10 000	192	NK40/30	IR354030
	NA 4907	—	—	—	—	35 ⁰ _{-0.012}	55	20	0.6	42	39	41	51	32 000	50 200	9 500	178	RNA4907	IR354220
	—	NA 5907	—	—	—	35	55	27	0.6	42	39	41	51	42 900	73 200	9 500	256	RNA5907	IR354227
	—	—	NA 6907	—	—	35	55	36	0.6	42	39	41	51	54 800	100 000	9 500	320	RNA6907	IR354236
38	—	—	—	—	NKI 38/20	38 ⁰ _{-0.012}	53	20	0.3	43	40	42	51	30 500	58 100	9 500	136	NK43/20	IR384320
	—	—	—	—	NKI 38/30	38	53	30	0.3	43	40	42	51	43 700	92 500	9 500	205	NK43/30	IR384330
40	—	—	—	—	NKI 40/20	40	55	20	0.3	45	42	44	53	31 100	60 100	9 000	143	NK45/20	IR404520
	—	—	—	—	NKI 40/30	40	55	30	0.3	45	42	44	53	44 500	95 700	9 000	215	NK45/30	IR404530
	NA 4908	—	—	—	—	40 ⁰ _{-0.012}	62	22	0.6	48	44	47	58	41 600	67 400	8 500	245	RNA4908	IR404822
	—	NA 5908	—	—	—	40	62	30	0.6	48	44	47	58	58 000	103 000	8 500	348	RNA5908	IR404830
	—	—	NA 6908	—	—	40	62	40	0.6	48	44	47	58	71 300	134 400	8 500	440	RNA6908	IR404840
42	—	—	—	—	NKI 42/20	42 ⁰ _{-0.012}	57	20	0.3	47	44	46	55	31 500	62 300	8 500	149	NK47/20	IR424720
	—	—	—	—	NKI 42/30	42	57	30	0.3	47	44	46	55	45 200	99 000	8 500	225	NK47/30	IR424730
45	—	—	—	—	NKI 45/25	45	62	25	0.6	50	49	49.5	58	43 000	85 200	8 000	230	NK50/25	IR455025
	—	—	—	—	NKI 45/35	45	62	35	0.6	50	49	49.5	58	58 100	125 500	8 000	320	NK50/35	IR455035
	NA 4909	—	—	—	—	45 ⁰ _{-0.012}	68	22	0.6	52	49	51	64	43 500	73 400	7 500	285	RNA4909	IR455222
	—	NA 5909	—	—	—	45	68	30	0.6	52	49	51	64	60 700	112 000	7 500	396	RNA5909	IR455230
	—	—	NA 6909	—	—	45	68	40	0.6	52	49	51	64	74 600	147 100	7 500	520	RNA6909	IR455240
50	—	—	—	—	NKI 50/25	50	68	25	0.6	55	54	54.5	64	45 400	94 100	7 500	270	NK55/25	IR505525
	—	—	—	—	NKI 50/35	50	68	35	0.6	55	54	54.5	64	61 300	138 300	7 500	365	NK55/35	IR505535
	NA 4910	—	—	—	—	50 ⁰ _{-0.012}	72	22	0.6	58	54	57	68	46 200	82 100	7 000	295	RNA4910	IR505822
	—	NA 5910	—	—	—	50	72	30	0.6	58	54	57	68	64 400	126 000	7 000	498	RNA5910	IR505830
	—	—	NA 6910	—	—	50	72	40	0.6	58	54	57	68	79 100	163 800	7 000	530	RNA6910	IR505840

* Suitable for oil lubrication. In case of grease lubrication, down to 60% of this value.

MACHINED RING NEEDLE ROLLER BEARINGS

WITH INNER RING

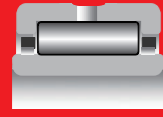

NA49,NA59,NKI



NA69

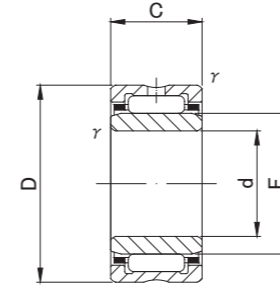

NA49,NA59,NKI

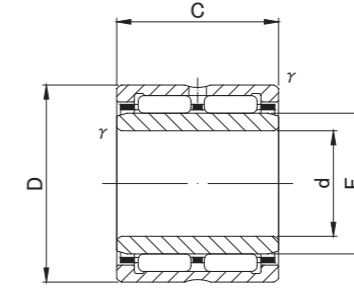

NA69

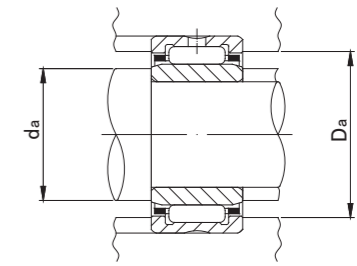

NA49,NA59,NA69,NA48,NKI TYPE

Shaft Diameter (mm)	Designation					Dimensions (mm)						Standard mounting dimensions (mm)		Basic dynamic load rating	Basic static load rating	Limiting speed*	Mass	Usable bearing designation	
	NA 49	NA 59	NA 69	NA48	NKI	d	D	C	r/s min	F	da		Da	Cr N	Cor N	rpm	g (approx)	OUTER RING	INNER RING
											MIN	MAX							
55	—	—	—	—	NKI 55/25	55	72	25	0.6	60	59	59.5	68	47 500	103 000	6 500	275	NK60/25	IR556025
	—	—	—	—	NKI 55/35	55	72	35	0.6	60	59	59.5	68	64 100	151 000	6 500	380	NK60/35	IR556035
	NA 4911	—	—	—	—	55 ⁰ _{-0.015}	80	25	1	63	60	61	75	57 600	97 300	6 500	410	RNA4911	IR556325
	—	NA 5911	—	—	—	55	80	34	1	63	60	61	75	82 600	154 000	6 500	559	RNA5911	IR556334
	—	—	NA 6911	—	—	55	80	45	1	63	60	61	75	99 000	194 200	6 500	730	RNA6911	IR556345
60	—	—	—	—	NKI 60/25	60	82	25	0.6	68	64	66	78	54 800	116 700	6 000	395	NK68/25	IR606825
	—	—	—	—	NKI 60/35	60	82	35	0.6	68	64	66	78	72 100	165 700	6 000	560	NK68/35	IR606835
	NA 4912	—	—	—	—	60 ⁰ _{-0.015}	85	25	1	68	64	66	80	60 100	104 900	6 000	440	RNA4912	IR606825
	—	NA 5912	—	—	—	60	85	34	1	68	65	66	80	86 100	167 000	6 000	614	RNA5912	IR606834
	—	—	NA 6912	—	—	60	85	45	1	68	65	66	80	103 000	210 800	6 000	785	RNA6912	IR606845
65	NA 4913	—	—	—	—	65	90	25	1	72	70	70.5	85	62 800	113 800	5 500	470	RNA4913	IR657225
	—	NA 5913	—	—	—	65 ⁰ _{-0.015}	90	34	1	72	70	70.5	85	89 900	180 000	5 500	655	RNA5913	IR657234
	—	—	—	—	NKI 65/35	65	90	35	0.6	73	69	71	86	80 400	180 400	5 500	710	NK73/35	IR657335
	—	—	NA 6913	—	—	65	90	45	1	72	70	70.5	85	107 900	226 500	5 500	840	RNA6913	IR657245
	—	—	—	—	—	—	—	—	—	—	—	—	—	—	—	—	—	—	—
70	—	—	—	—	NKI 70/25	70	95	25	1	80	75	78	90	59 400	137 300	5 000	540	NK80/25	IR708025
	—	—	—	—	NKI 70/35	70	95	35	1	80	75	78	90	78 100	194 200	5 000	755	NK80/35	IR708035
	NA 4914	—	—	—	—	70 ⁰ _{-0.015}	100	30	1	80	75	78	95	83 200	157 900	5 000	765	RNA4914	IR708030
	—	NA 5914	—	—	—	70	100	40	1	80	75	78	95	112 000	232 000	5 000	1 060	RNA5914	IR708040
	—	—	NA 6914	—	—	70	100	54	1	80	75	78	95	133 400	310 900	5 000	1 400	RNA6914	IR708054
75	—	—	—	—	NKI 75/25	75	105	25	1	85	80	83	100	76 400	145 100	4 500	675	NK85/25	IR758525
	NA 4915	—	—	—	—	75	105	30	1	85	80	83	100	86 200	169 700	4 500	810	RNA4915	IR758530
	—	—	—	—	NKI 75/35	75 ⁰ _{-0.015}	105	35	1	85	80	83	100	102 000	209 900	4 500	945	NK85/35	IR758535
	—	NA 5915	—	—	—	75	105	40	1	85	80	83	100	116 000	249 000	4 500	1 130	RNA5915	IR758540
	—	—	NA 6915	—	—	75	105	54	1	85	80	83	100	138 300	330 500	4 500	1 480	RNA6915	IR758554
80	—	—	—	—	NKI 80/25	80	110	25	1	90	85	88	105	77 400	150 000	4 500	710	NK90/25	IR809025
	NA 4916	—	—	—	—	80	110	30	1	90	85	88	105	87 400	174 600	4 500	855	RNA4916	IR809030
	—	—	—	—	NKI 80/35	80 ⁰ _{-0.015}	110	35	1	90	85	88	105	103 000	216 700	4 500	995	NK90/35	IR809035
	—	NA 5916	—	—	—	80	110	40	1	90	85	88	105	117 000	257 000	4 500	1 150	RNA5916	IR809040
	—	—	NA 6916	—	—	80	110	54	1	90	85	88	105	143 200	350 100	4 500	1 560	RNA6916	IR809054
85	—	—	—	—	NKI 85/26	85	115	26	1	95	90	93	110	79 700	158 900	4 200	775	NK95/26	IR859526
	—	—	—	—	NKI 85/36	85	115	36	1	95	90	93	110	106 900	230 500	4 200	1 080	NK95/36	IR859536
	NA 4917	—	—	—	—	85 ⁰ _{-0.020}	120	35	1.1	100	91.5	98	113.5	109 800	244 200	4 000	1 280	RNA4917	IR8510035
	—	NA 5917	—	—	—	85	120	46	1.1	100	91.5	98	113.5	144 000	346 000	4 000	1 760	RNA5917	IR8510046
	—	—	NA 6917	—	—	85	120	63	1.1	100	91.5	98	113.5	172 600	466 800	4 000	2 340	RNA6917	IR8510063

* Suitable for oil lubrication. In case of grease lubrication, down to 60% of this value.

MACHINED RING NEEDLE ROLLER BEARINGS

WITH INNER RING

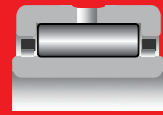

NA49,NA59,NA48,NKI



NA69

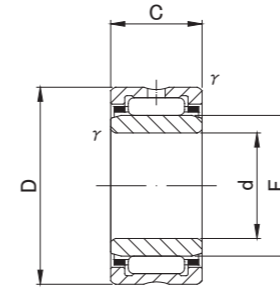

NA49,NA59,NA48,NKI

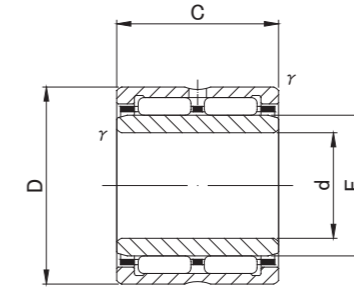

NA69

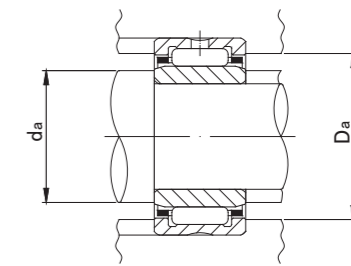

NA49,NA59,NA69,NA48,NKI TYPE

Shaft Diameter (mm)	Designation					Dimensions (mm)					Standard mounting dimensions (mm)		Basic dynamic load rating	Basic static load rating	Limiting speed*	Mass	Usable bearing designation		
	NA 49	NA 59	NA 69	NA 48	NKI	d	D	C	r/s min	F	da		Da	Cr N	Cor N	rpm	g (approx)	OUTER RING	INNER RING
											MIN	MAX							
90	—	—	—	—	NKI 90/26	90	120	26	1	100	95	98	115	82 500	168 700	4 000	820	NK100/26	IR9010026
	—	—	—	—	NKI 90/36	90	120	36	1	100	95	98	115	109 800	244 200	4 000	1 140	NK100/36	IR9010036
	NA 4918	—	—	—	—	90 ⁰ _{-0.020}	125	35	1.1	105	96.5	103	118.5	112 800	257 900	3 800	1 350	RNA4918	IR9010535
	—	NA 5918	—	—	—	90	125	46	1.1	105	96.5	103	118.5	148 000	365 000	3 800	1 840	RNA5918	IR9010546
	—	—	NA 6918	—	—	90	125	63	1.1	105	96.5	103	118.5	177 500	490 300	3 800	2 460	RNA6918	IR9010563
95	—	—	—	—	NKI 95/26	95	125	26	1	105	100	103	120	84 700	177 500	3 800	860	NK105/26	IR9510526
	—	—	—	—	NKI 95/36	95	125	36	1	105	100	103	120	112 800	257 900	3 800	1 190	NK105/36	IR9510536
	NA 4919	—	—	—	—	95 ⁰ _{-0.020}	130	35	1.1	110	101.5	108	123.5	116 700	270 700	3 600	1 420	RNA4919	IR9511035
	—	NA 5919	—	—	—	95	130	46	1.1	110	101.5	108	123.5	152 000	384 000	3 600	1 980	RNA5919	IR9511046
	—	—	NA 6919	—	—	95	130	63	1.1	110	101.5	108	123.5	182 400	514 800	3 600	2 580	RNA6919	IR9511063
100	—	—	—	—	NKI 100/30	100	130	30	1.1	110	106.5	108	123.5	105 900	239 300	3 600	1 040	NK110/30	IR10011030
	—	—	—	—	NKI 100/40	100 ⁰ _{-0.020}	130	40	1.1	110	106.5	108	123.5	133 400	323 600	3 600	1 380	NK110/40	IR10011040
	NA 4920	—	—	—	—	100	140	40	1.1	115	106.5	113	133.5	145 000	329 000	3 500	1 960	RNA4920	IR10011540
110	—	—	—	NA 4822	—	110 ⁰ _{-0.020}	140	30	1	120	115	118	135	93 000	239 000	3 500	1 200	RNA4822	IR11012030
	NA 4922	—	—	—	—	110	150	40	1.1	125	116.5	123	143.5	152 000	357 000	3 000	2 120	RNA4922	IR11012540
120	—	—	—	NA 4824	—	120 ⁰ _{-0.020}	150	30	1	130	125	128	145	97 000	259 000	3 000	1 300	RNA4824	IR12013030
	NA 4924	—	—	—	—	120	165	45	1.1	135	126.5	133	158.5	187 000	435 000	3 000	2 960	RNA4924	IR12013545
130	—	—	—	NA 4826	—	130 ⁰ _{-0.025}	165	35	1.1	145	136.5	143	158.5	117 000	340 000	3 000	1 960	RNA4826	IR13014535
	NA 4926	—	—	—	—	130	180	50	1.5	150	138	148	172	216 000	540 000	2 500	4 030	RNA4926	IR13015050
140	—	—	—	NA 4828	—	140 ⁰ _{-0.025}	175	35	1.1	155	146.5	153	168.5	121 000	363 000	2 500	2 100	RNA4828	IR14015535
	NA 4928	—	—	—	—	140	190	50	1.5	160	148	158	182	224 000	580 000	2 500	4 290	RNA4928	IR14016050
150	—	—	—	NA 4830	—	150 ⁰ _{-0.025}	190	40	1.1	165	156.5	163	183.5	168 000	446 000	2 500	2 880	RNA4830	IR15016540
160	—	—	—	NA 4832	—	160 ⁰ _{-0.025}	200	40	1.1	175	166.5	173	193.5	173 000	474 000	2 500	3 050	RNA4832	IR16017540

* Suitable for oil lubrication. In case of grease lubrication, down to 60% of this value.

MACHINED RING NEEDLE ROLLER BEARINGS

SEALED, WITHOUT INNER RING

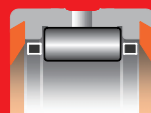

RNA49UU, RNA69UU ($F_w \leq 35$)



RNA69UU

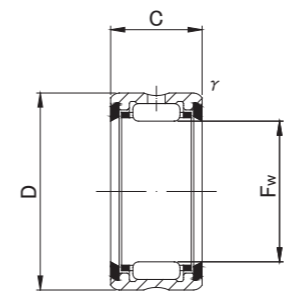

RNA49UU, RNA69UU ($F_w \leq 35$)

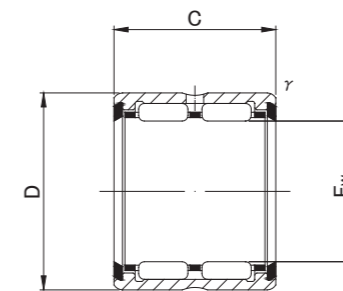

RNA69UU

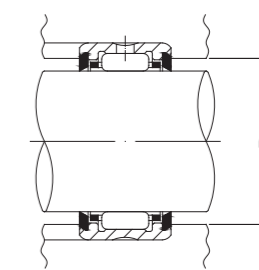

RNA49UU, RNA69UU, SEALED TYPE

Prepacked Grease

Shaft Diameter (mm)	Designation		Dimensions (mm)					Standard mounting dimensions (mm)	Basic dynamic load rating	Basic static load rating	Limiting speed (GREASE)	Mass	Usable bearing designation	
	RNA 49UU	RNA 69UU	F_w	D	C	r_s min	D_a MAX						Cr N	Cor N
14	RNA 4900UU	—	14 $+0.027$ $+0.016$	22	13	0.3	20	8 000	8 500	14 000	16	IRZ101414	NA4900UU	
16	RNA 4901UU	—	16 $+0.027$	24	13	0.3	22	8 400	9 300	12 000	18	IRZ121614	NA4901UU	
	—	RNA 6901UU	16 $+0.016$	24	22	0.3	22	15 600	20 400	12 000	30	IRZ121623	NA6901UU	
20	RNA 4902UU	—	20 $+0.033$	28	13	0.3	26	9 600	11 700	9 500	22	IRZ152014	NA4902UU	
	—	RNA 6902UU	20 $+0.020$	28	23	0.3	26	18 400	27 100	9 500	38	IRZ152024	NA6902UU	
22	RNA 4903UU	—	22 $+0.033$	30	13	0.3	28	10 300	13 100	8 500	23	IRZ172214	NA4903UU	
	—	RNA 6903UU	22 $+0.020$	30	23	0.3	28	19 800	30 600	8 500	40	IRZ172224	NA6903UU	
25	RNA 4904UU	—	25 $+0.033$	37	17	0.3	35	17 900	20 500	7 500	55	IRZ202518	NA4904UU	
	—	RNA 6904UU	25 $+0.020$	37	30	0.3	35	33 000	44 500	7 500	96	IRZ202531	NA6904UU	
30	RNA 4905UU	—	30 $+0.033$	42	17	0.3	40	20 300	25 100	6 500	63	IRZ253018	NA4905UU	
	—	RNA 6905UU	30 $+0.020$	42	30	0.3	40	39 200	58 600	6 500	110	IRZ253031	NA6905UU	
35	RNA 4906UU	—	35 $+0.041$	47	17	0.3	45	21 600	28 400	5 500	71	IRZ303518	NA4906UU	
	—	RNA 6906UU	35 $+0.025$	47	30	0.3	45	40 100	63 100	5 500	130	IRZ303531	NA6906UU	
42	RNA 4907UU	—	42 $+0.041$	55	20	0.6	51	30 100	46 300	4 500	110	IRZ354221	NA4907UU	
	—	RNA 6907UU	42 $+0.025$	55	36	0.6	51	51 600	92 600	4 500	200	IRZ354237	NA6907UU	
48	RNA 4908UU	—	48 $+0.041$	62	22	0.6	58	37 200	58 300	4 000	150	IRZ404823	NA4908UU	
	—	RNA 6908UU	48 $+0.025$	62	40	0.6	58	63 700	116 700	4 000	270	IRZ404841	NA6908UU	
52	RNA 4909UU	—	52 $+0.049$	68	22	0.6	64	38 800	63 400	3 500	190	IRZ455223	NA4909UU	
	—	RNA 6909UU	52 $+0.030$	68	40	0.6	64	66 700	126 500	3 500	355	IRZ455241	NA6909UU	
58	RNA 4910UU	—	58 $+0.049$	72	22	0.6	68	41 300	71 100	3 500	180	IRZ505823	NA4910UU	
	—	RNA 6910UU	58 $+0.030$	72	40	0.6	68	70 800	142 200	3 500	320	IRZ505841	NA6910UU	

MACHINED RING NEEDLE ROLLER BEARINGS

SEALED, WITH INNER RING

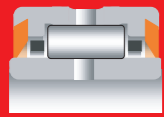

NA49UU,NA69UU(d≤30)



NA69UU

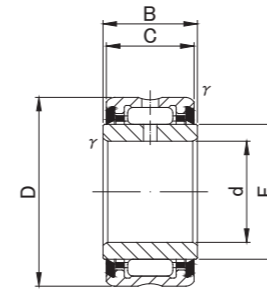

NA49UU,NA69UU(d ≤ 30)

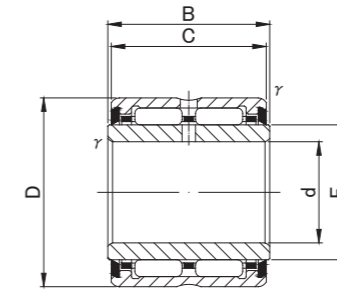

NA69UU

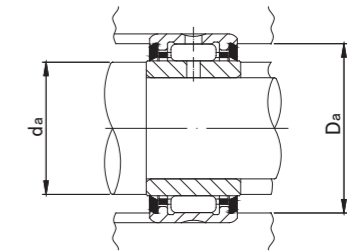

NA49UU,NA69UU,SEALED TYPE

Prepacked Grease

Shaft Diameter (mm)	Designation		Dimensions (mm)						Standard mounting dimensions (mm)			Basic dynamic load rating	Basic static load rating	Limiting speed (GREASE)	Mass	Usable bearing designation	
	NA 49UU	NA 69UU	d	D	C	B	l/s min	F	da		Da	Cr N	Cor N	rpm	g (approx)	OUTER RING	INNER RING
									MIN	MAX	MAX						
10	NA 4900UU	—	10 ⁰ _{-0.008}	22	13	14	0.3	14	12	13	20	8 000	8 500	14 000	25	RNA4900UU	IRZ101414
12	NA 4901UU	—	12 ⁰ _{-0.008}	24	13	14	0.3	16	14	15	22	8 400	9 300	12 000	28	RNA4901UU	IRZ121614
	—	NA 6901UU	12 ⁰ _{-0.008}	24	22	23	0.3	16	14	15	22	15 600	20 400	12 000	46	RNA6901UU	IRZ121623
15	NA 4902UU	—	15 ⁰ _{-0.008}	28	13	14	0.3	20	17	19	26	9 600	11 700	9 500	36	RNA4902UU	IRZ152014
	—	NA 6902UU	15 ⁰ _{-0.008}	28	23	24	0.3	20	17	19	26	18 400	27 100	9 500	63	RNA6902UU	IRZ152024
17	NA 4903UU	—	17 ⁰ _{-0.008}	30	13	14	0.3	22	19	21	28	10 300	13 100	8 500	40	RNA4903UU	IRZ172214
	—	NA 6903UU	17 ⁰ _{-0.008}	30	23	24	0.3	22	19	21	28	19 800	30 600	8 500	69	RNA6903UU	IRZ172224
20	NA 4904UU	—	20 ⁰ _{-0.010}	37	17	18	0.3	25	22	24	35	17 900	20 500	7 500	78	RNA4904UU	IRZ202518
	—	NA 6904UU	20 ⁰ _{-0.010}	37	30	31	0.3	25	22	24	35	33 000	44 500	7 500	140	RNA6904UU	IRZ202531
25	NA 4905UU	—	25 ⁰ _{-0.010}	42	17	18	0.3	30	27	29	40	20 300	25 100	6 500	93	RNA4905UU	IRZ253018
	—	NA 6905UU	25 ⁰ _{-0.010}	42	30	31	0.3	30	27	29	40	39 200	58 600	6 500	162	RNA6905UU	IRZ253031
30	NA 4906UU	—	30 ⁰ _{-0.010}	47	17	18	0.3	35	32	34	45	21 600	28 400	5 500	106	RNA4906UU	IRZ303518
	—	NA 6906UU	30 ⁰ _{-0.010}	47	30	31	0.3	35	32	34	45	40 100	63 100	5 500	185	RNA6906UU	IRZ303531
35	NA 4907UU	—	35 ⁰ _{-0.012}	55	20	21	0.6	42	39	41	51	30 100	46 300	4 500	179	RNA4907UU	IRZ354221
	—	NA 6907UU	35 ⁰ _{-0.012}	55	36	37	0.6	42	39	41	51	51 600	92 600	4 500	320	RNA6907UU	IRZ354237
40	NA 4908UU	—	40 ⁰ _{-0.012}	62	22	23	0.6	48	44	47	58	37 200	58 300	4 000	245	RNA4908UU	IRZ404823
	—	NA 6908UU	40 ⁰ _{-0.012}	62	40	41	0.6	48	44	47	58	63 700	116 700	4 000	440	RNA6908UU	IRZ404841
45	NA 4909UU	—	45 ⁰ _{-0.012}	68	22	23	0.6	52	49	51	64	38 800	63 400	3 500	290	RNA4909UU	IRZ455223
	—	NA 6909UU	45 ⁰ _{-0.012}	68	40	41	0.6	52	49	51	64	66 700	126 500	3 500	510	RNA6909UU	IRZ455241
50	NA 4910UU	—	50 ⁰ _{-0.012}	72	22	23	0.6	58	54	57	68	41 300	71 100	3 500	300	RNA4910UU	IRZ505823
	—	NA 6910UU	50 ⁰ _{-0.012}	72	40	41	0.6	58	54	57	68	70 800	142 200	3 500	530	RNA6910UU	IRZ505841